

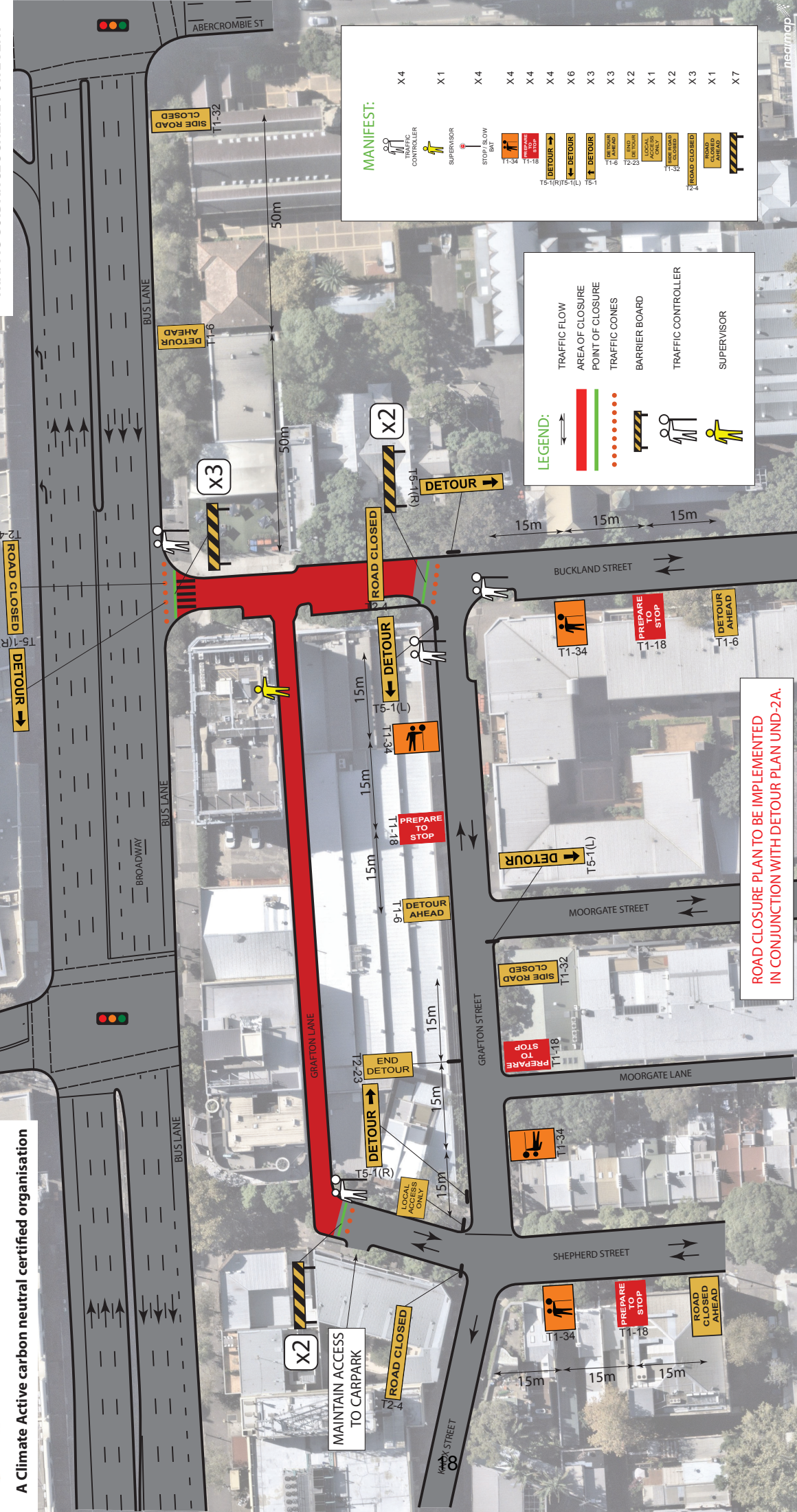

A Climate Active carbon neutral certified organisation



TRAFFIC GUIDANCE SCHEME FOR EVENT



LEGEND:

- TRAFFIC FLOW:
- AREA OF CLOSURE:
- POINT OF CLOSURE:
- TRAFFIC CONES:
- BARRIER BOARD:
- TRAFFIC CONTROLLER:
- SUPERVISOR:

ROAD CLOSURE PLAN TO BE IMPLEMENTED IN CONJUNCTION WITH DETOUR PLAN UND-2A.

DRAWN BY: MATTHEW YOUNG	TCT 0048974		PROJECT: UNIVERSITY OF NOTRE DAME - OPEN DAY 2024	APPROVAL REQUIRED:	EVENT TIMES: 10AM - 3PM	PLAN NO.
AUTHORISED BY: KIERAN CATO	TCT 0040880		CLIENT: UNIVERSITY OF NOTRE DAME	LOCAL <input checked="" type="checkbox"/>	SETUP FROM 5AM	UND-1
			LOCATION: BUCKLAND STREET, CHIPPENDALE NSW	STATE <input checked="" type="checkbox"/>	PACKDOWN FINISH 6PM	VAR: (A) TGS 2.0
			CONTACT: CLAIRE YOUNG	INSW <input type="checkbox"/>	SITE SPECIFICS:	EVENT DATE: 31/08/2024
			COUNCIL: CITY OF SYDNEY	OTHER <input type="checkbox"/>	TRAFFIC LIGHTS <input checked="" type="checkbox"/>	PLAN DATE: 19/04/2024
			ORIGINAL SIZE: AS LANDSCAPE		BUS STOPS <input type="checkbox"/>	
			NTS		EXISTING WORKS <input type="checkbox"/>	
					SCHOOL OR HOSPITAL <input checked="" type="checkbox"/>	



1. THIS TRAFFIC GUIDANCE SCHEME HAS BEEN DRAWN IN ACCORDANCE WITH AS 1923 AND TRAFFIC CONTROL AT WORKSITES - MANUAL W.1.
 2. SIGNS & DEVICES ARE TO BE PLACED IN ACCORDANCE WITH THIS FOR MODIFICATION MAY BE MADE BY PERSONS HOLDING A TIME DESIGN & AUDIT QUALIFICATION ONLY.
 3. ALL SIGNS AND DEVICES USED MUST COMPLY WITH AUSTRALIAN STANDARD AS 1923.
 4. THIS DOCUMENT IS COPYRIGHT / PROPERTY OF CRA+O LOGISTICS PTY LTD. THIS DRAWING SHALL ONLY BE USED FOR THE PURPOSE FOR WHICH IT IS INTENDED. UNAUTHORISED USE OF THIS DRAWING IS PROHIBITED.